

One-Click™ Cleaner MU/LC Mini Instruction Manual

Thank you for choosing the **One-Click™ Cleaner MU/LC Mini**. The **One-Click™ Cleaner MU/LC Mini** is a high-performance device designed for cleaning the ferrule end faces of MU/LC connectors. Carefully read this instruction manual before using this device. Please keep this instruction manual for future reference.

1. Safety precautions

	Though our device is deemed safe, improper usage or handling can still inflict injury to others.
	One-Click™ Cleaner MU/LC Mini is designed to clean MU and LC connectors only. Fujikura is not liable for damage caused in attempt to apply this device to other applications.

2. Notes on usage

- Do not attempt to disassemble as this can cause damage to the device.
- Do not re-use cleaning cloth as this will eliminate its cleaning ability.
- Do not touch the cleaning cloth as this will cause contamination.
- Do not pull the cleaning cloth, use only the device body.
- Do not use this cleaner when the cloth is empty, as this can cause damage to the connector.

3. Notes on storage for extended periods

- Do not expose device to direct sunlight, high temperature or high humidity.
- The cover on the guide cap should be closed at all times when device is not in use.

4. Sales enquiries

Fiber Optics Components & System Div. Fujikura Ltd
 1-5-1 Kiba, Koto-ku, Tokyo 135-8512, JAPAN
 TEL: +81-3-5606-1205 FAX: +81-3-5606-1536
 E-mail: telcon@fujikura.co.jp

5. Device construction

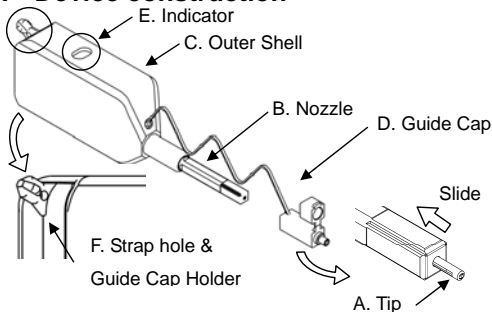

	View of Indicator	View of the Nozzle end
Full	Cloth (White)	Tip (Black) Cloth (White)
Little	Cloth (White) Red	Slide Tip (Black) Cloth (White)
Empty	Red	Slide Tip (Black) No Cloth (Black)

Identification of remaining cloth

No.	Part Name	Function
A	Tip	Lead the cleaning cloth to the optical connector end face.
B	Nozzle	Lead tip to the optical connector end face.
C	Outer Shell	Push the outer shell to clean the connector.
D	Guide Cap	Acts as dust cap or cleaning adaptor for connector plug.
E	Indicator	Provides indication of remaining cleaning cloth.
F	Strap hole & Guide Cap Holder	Can pass the strings through the strap hole. The guide cap can be fixed to a fixed part.

6. Applications

<Connector inside adaptor>

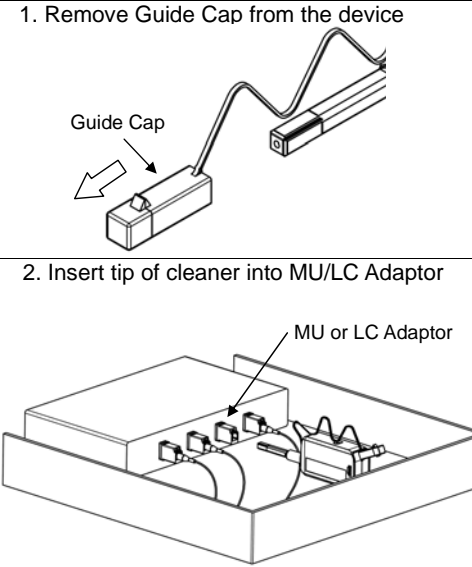

Note: This drawing shows only LC, but this product can clean MU too.

3. Push the Outer Shell to start cleaning the MU/LC connector end face. A "click" sound indicates end of cleaning process. Close the cover after use.

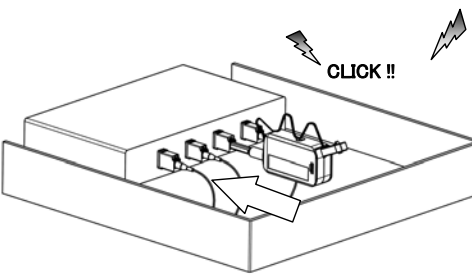

Be careful not to slant the One-Click™ Cleaner MU/LC Mini while inserting into the adaptor.

Do not overly exert force during insertion as this may cause damage to both the connector and the One-Click™ Cleaner MU/LC Mini.

If pushing Outer Shell is inhibited, remove One-Click™ Cleaner MU/LC Mini from adaptor and ensure that there is no sizeable debris inhibiting the cleaning process.

<Connector plugs alone>

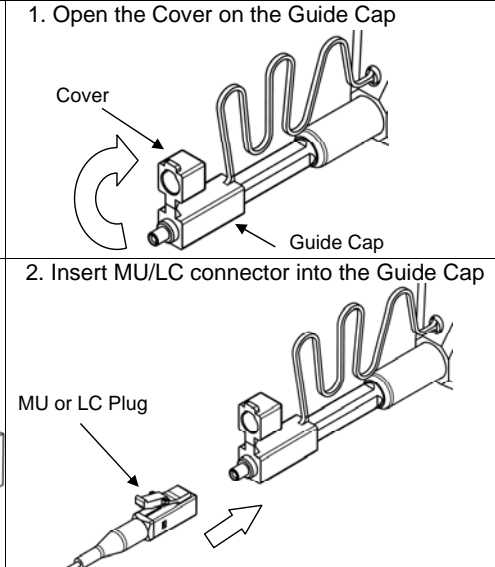

Note: This drawing shows only LC, but this product can clean MU too.

3. Push the Outer Shell to start cleaning the MU/LC connector end face. A "click" sound indicates end of cleaning process. Close the cover after use.

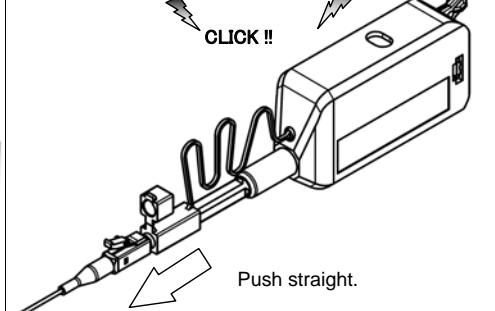

Be careful not to slant MU/LC connector while inserting into the Guide cap.

Do not overly exert force during insertion as this may cause damage to both the connector and the One-Click™ Cleaner MU/LC Mini.

If pushing Outer Shell is inhibited, remove One-Click™ Cleaner MU/LC Mini from adaptor and ensure that there is no sizeable debris inhibiting the cleaning process.